

Y=160m (TO NEAREST EDGE OF APPROACHING LANE AS PET TII DN-GEO-03060-TABLE 5.4 & 5.5)

Y=160m (TO NEAREST EDGE OF APPROACHING LANE AS PET TII DN-GEO-03060-TABLE 5.4 & 5.5)

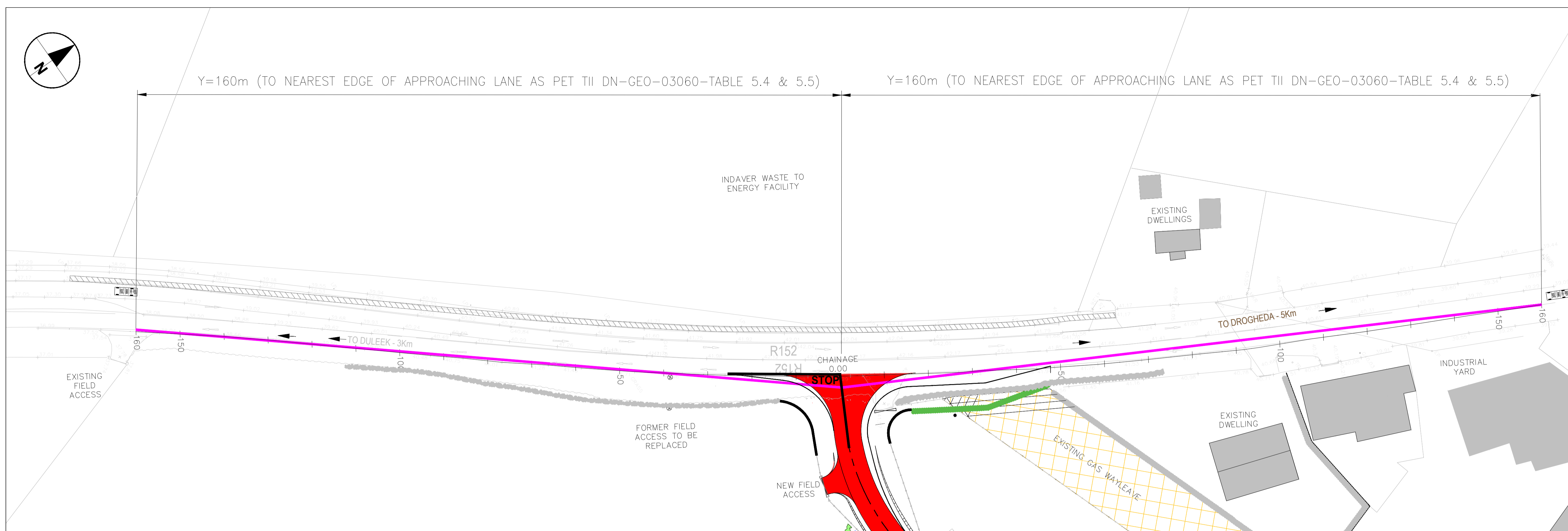

PLAN - VISIBILITY FROM PROPOSED JUNCTION
SCALE 1:500

CONSTRUCTION RISKS **MAINTENANCE / CLEANING RISK** **DEMOLITION RISKS**

In addition to the hazard/risks normally associated with the types of work detailed on this drawing take note of above. It is assumed that all works on this drawing will be carried out by a competent contractor working, where appropriate, to an appropriate method statement.

SAFETY, HEALTH AND ENVIRONMENTAL INFORMATION BOX

- LEGEND**
- PROPOSED ACCESS ROAD
 - EXISTING GAS WAYLEAVE
 - PROPOSED LINE OF VISIBILITY (X=3m)
 - VEHICLE APPROACHING FROM R152
 - SSE AIRTRICITY LAND OWNERSHIP
 - PROPOSED NATURAL STONE WALLS
 - PROPOSED FENCELINE
 - EXISTING HEDGE
 - PROPOSED HEDGE REPLANTING PHASE 2

--	--

PROJECT TITLE AMENDED	By	Date	Suffix
		28/11/18	A

Purpose of issue: **PLANNING**

Client: **SSE GENERATION IRELAND LTD**

Project Title: **PROPOSED 110kV TRANSMISSION SUBSTATION**

Drawing Title: **PROPOSED SIGHTLINES**

Designed GMCE	Drawn GMCE	Checked CGY	Approved CGY	Date NOV18
URS Internal Project No. Subtitle				
Scale @ A1 Zone / Mileage				

This document has been prepared in accordance with the scope of AECOM appointment with its client and is subject to the terms of that appointment. AECOM accepts no liability for any use of this document other than by its client and only for the purposes for which it was prepared and provided. Only written dimensions shall be used.

© AECOM

AECOM
97 HAYMARKET TERRACE
EDINBURGH
EH12 5HD
TEL 0131-347-1100
FAX 0131-347-1101
www.aecom.com

Drawing Number 60581192/0806	Rev A
--	-----------------

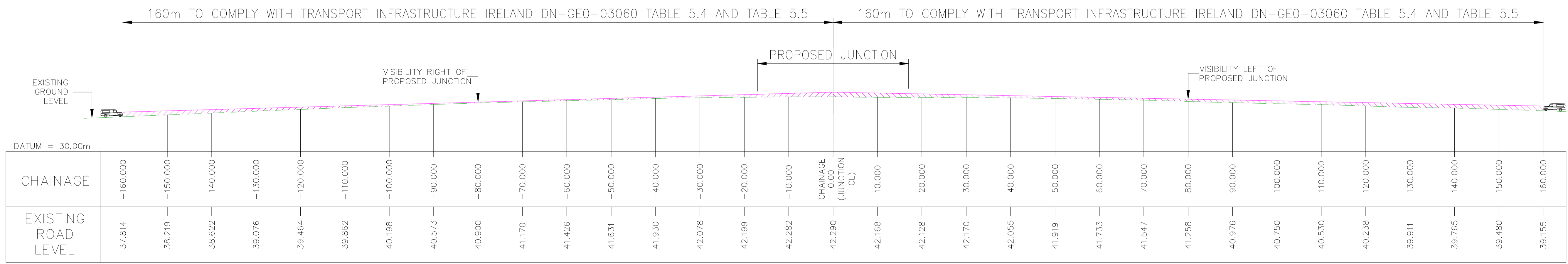

LONGITUDINAL PROFILE THROUGH PROPOSED VISIBILITY SIGHTLINES
SCALE 1:500 H&V

